

- NOTES:
1. DO NOT SCALE DRAWING.
 2. DIMENSIONS ARE IN INCHES [mm].
 3. LHR DOOR SHOWN.
 4. MINIMUM STILE WIDTH: 4 1/2" [114.3].
 5. DIMENSION FROM BOTTOM OF DOOR TO BOTTOM HOLE IS 1-7/16" [36.5] OR IF A RAISED OR ELEVATED SILL CONDITION EXISTS, MOVE HOLE LOCATION UP THE THICKNESS OF THE SILL CONDITION FROM THE BOTTOM OF DOOR.
 6. REQUIRED FOR DOOR HEIGHTS OVER 7'0", OR IF DISTANCE BETWEEN DEVICE CENTER LINE TO TOP OF DOOR EXCEEDS 44".
 7. 3/16" [4.8] PILOT HOLE. IF REQUIRED, THRU-BOLT HOLE SIZE 9/32" INTERIOR DOOR FACE, AND 3/8" EXTERIOR DOOR FACE.
 8. PLEASE REFER TO HOLE DETAIL ON PAGE 2

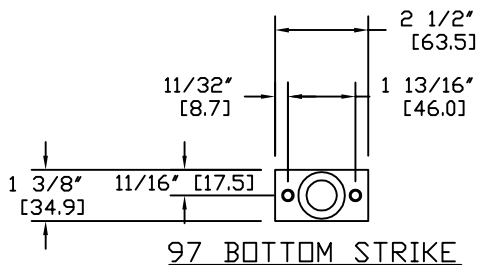
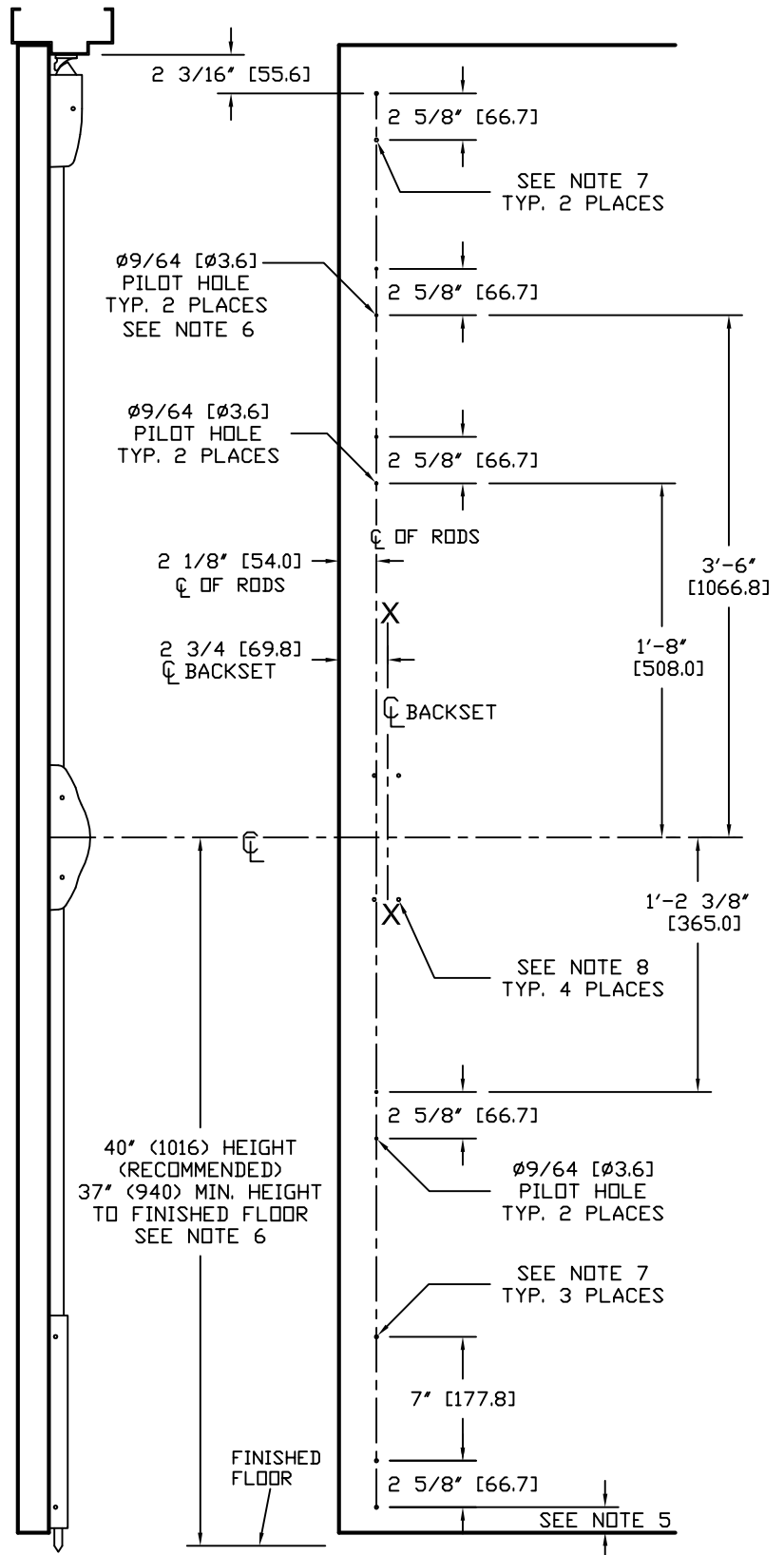

HDG. _____ DR. _____

RESPONSIBILITY
Door and Frame Manufacturers are responsible for providing adequate construction or reinforcements for proper installation of hardware shown. All architectural builders hardware must be installed on properly reinforced doors and frames regardless of the type, material or method of construction.

TEMPLATE
WOOD DOOR
2001 & F2001 SERIES
VERICAL ROD EXIT DEVICE
BP-1 MOUNTING PLATE

DETEx
CORPORATION

DO NOT SCALE DRAWING

DATE
3-29-10

TEMPLATE NUMBER
T1065 Pg 1 OF 2

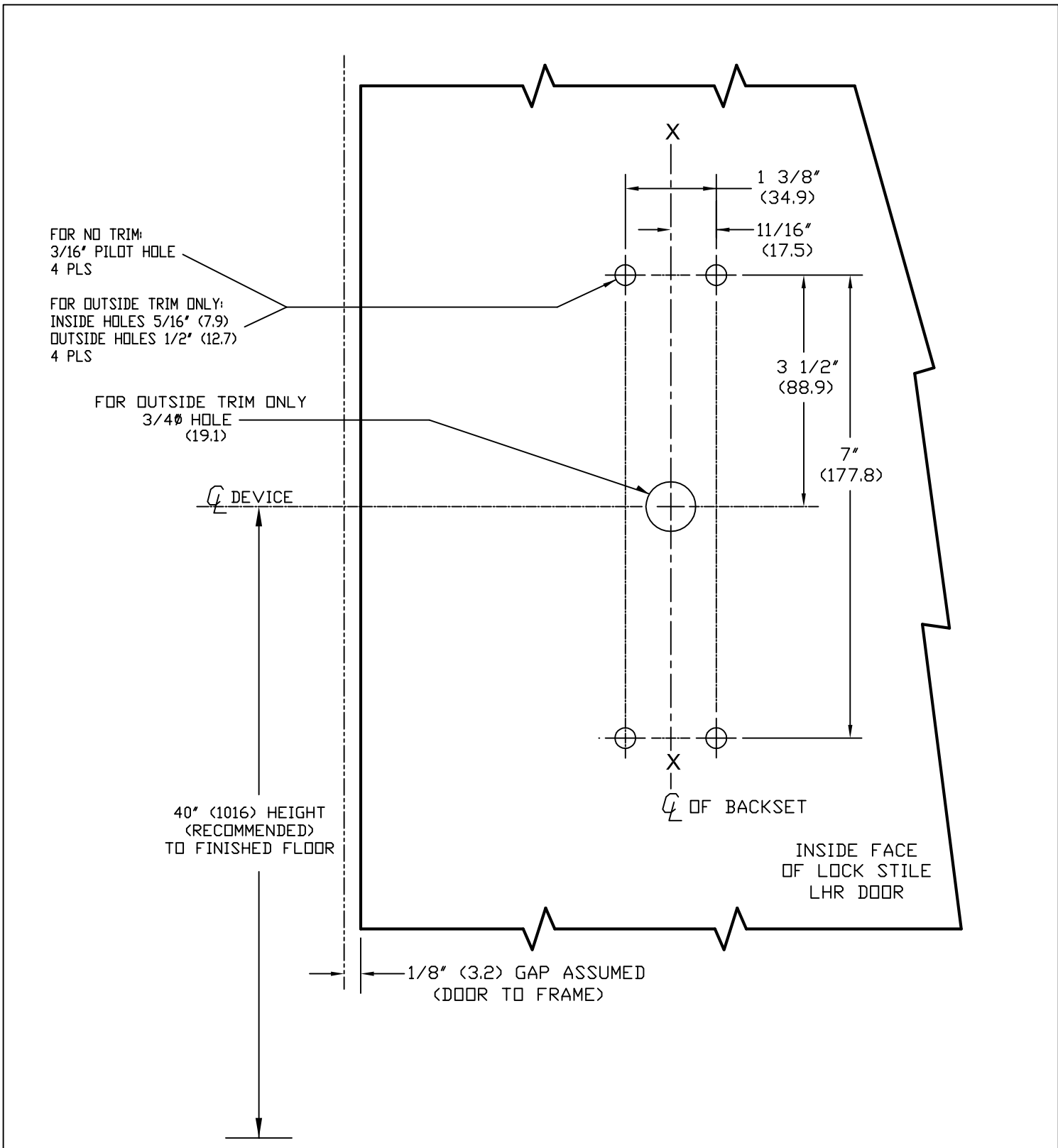

- NOTES:
1. LHR SHOWN; RHR OPPOSITE.
2. DIMENSIONS SHOWN IN INCHES AND (mm).

HDG. _____ DR. _____

RESPONSIBILITY
Door and Frame Manufacturers are responsible for providing adequate construction or reinforcements for proper installation of hardware shown. All architectural builders hardware must be installed on properly reinforced doors and frames regardless of the type, material or method of construction.

TEMPLATE
WOOD DOOR
2001 & F2001 SERIES
VERTICAL ROD EXIT DEVICE
BP-1 MOUNTING PLATE

DETEX
CORPORATION

DO NOT SCALE DRAWING

DATE 3-29-10	TEMPLATE NUMBER T1065 Pg 2 OF 2
-----------------	------------------------------------